

A Step-by-Step Guide to Backpotting

When using epoxy resins, always have a clean working area (and not to get resin on things you don't want it on)! Most epoxy resins are a two-part compound or a resin and a hardener, which stays liquid before mixing. Each compound has its own detailed instructions on mixing, application and drying times, but here is the basic step-by-step process that is generally applicable:

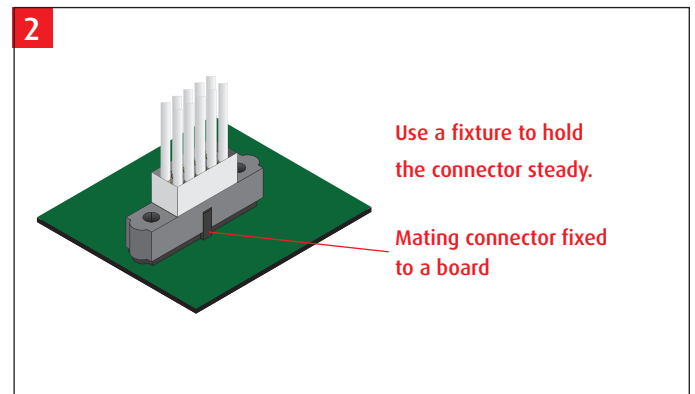

The simplest fixture is to glue a mating connector to a rigid board, and mate the connector being potted. Alternatively the connector could be held in a small vice – it is recommended that the connector is still mated in this method.

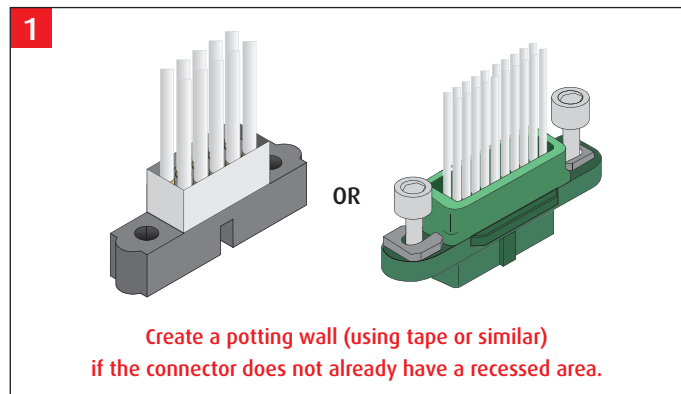
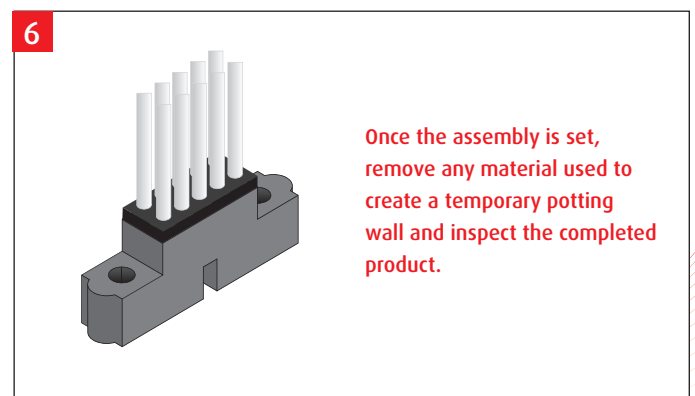
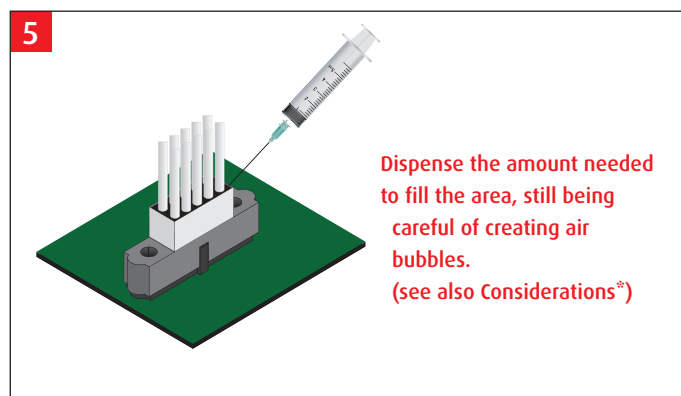
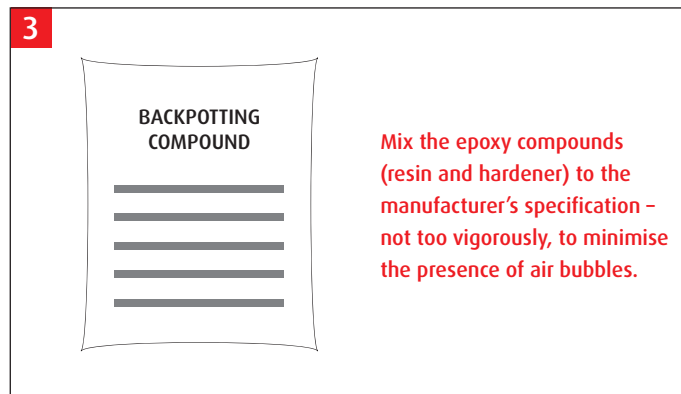

Considerations:

- If required, use a vacuum environment to de-gas the dispensed fluid – to remove trapped air bubbles.
- Place the assembly somewhere safe whilst the epoxy compound sets.
- For some resins, heat curing may be necessary.