

### About Amphenol Commercial Products

Amphenol's commercial connector products are used in a variety of end user applications including networking, telecom, server & computer, storage & HDD, consumer electronics and entertainment, professional audio & Industrial & Military/Aerospace.

### Related Products

#### RJHSE

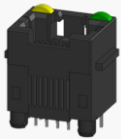

P/N RJHSE-3081 SHOWN SINGLE PORT VERTICAL MOUNT, NO SHIELD, WITH LEDs

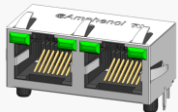

P/N RJHSE-5385-02 SHOWN TWO PORT REGULAR MOUNT, WITH SHIELD AND LEDs

#### RJSAE

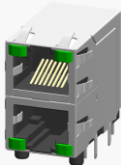

P/N RJSAE-5385-02 SHOWN STACKED 2X1, 8 POSITION, WITH SHIELD AND LEDs

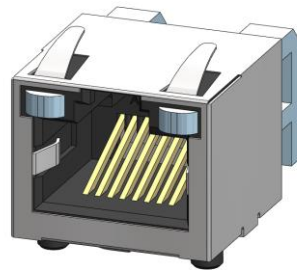

P/N RJSSE-5381 SHOWN SINGLE PORT, 8 POSITION, WITH SHIELD AND LIGHT PIPE

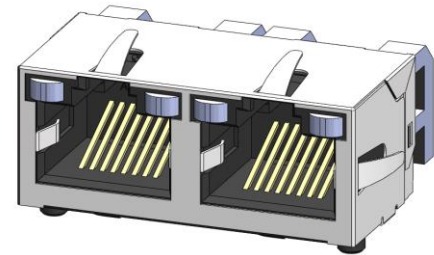

P/N RJSSE-5381-02 SHOWN DOUBLE PORT, 8 POSITION, WITH SHIELD AND LIGHT PIPE

### OVERVIEW

This product specification defines the general use and performance parameters for Amphenol's RJSSE Surface Mount series of inverted modular jacks.

Availability: Single and multiport connectors, shielded and unshielded versions available with or without light pipe option.

### USAGE

The RJSSE Surface Mount modular jacks supports Ethernet Protocols. Shielding available for increased EMI performance and Light Pipes for Link Activity and Network Speed verification.

### APPLICATIONS

Intended for use in applications such as:

#### Data

- Storage
- Servers
- Routers
- Switches
- Hubs

#### Consumer Goods

- Security Systems
- Set Top Boxes
- Video Game Systems
- PCs, Laptops
- Copiers, Printers

#### Industrial and Instrumentation

- Uninterruptible Power Supply (UPS)
- ATMs
- Vending Machines
- POS Terminals
- Industrial IoT Platforms

#### Networking & Telecom

- 5G Wireless
- Telephones
- Modems
- Fax Machines

#### Medical

- Analysis Equipment
- Mass Spectrometers

## About Amphenol Commercial Products

Amphenol's commercial connector products are used in a variety of end user applications including networking, telecom, server & computer, storage & HDD, consumer electronics and entertainment, professional audio & Industrial & Military/Aerospace.

## Related Products

### RJULE

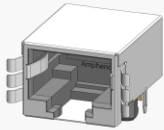

P/N RJULE-4X182-01 SHOWN SINGLE PORT REGULAR MOUNT, STANDARD SHIELD WITH SMT

### FRJAE



P/N FRJAE-418 SHOWN SINGLE PORT, 8 POSITION, WITH FERRITE FILTER AND SHIELD (FRONT TABS)

### RJLSE

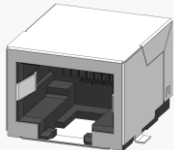

P/N RJLSE-41181-01 SHOWN SINGLE PORT REGULAR MOUNT, STANDARD SHIELD WITH SMT

## ELECTRICAL CHARACTERISTICS

<b>Contact Resistance</b>	20 mΩ maximum
<b>Insulation Resistance</b>	500 MΩ minimum at 500V DC for 2 minutes maximum
<b>Current Rating</b>	1.5 Amps per contact
<b>Voltage Rating</b>	125 Volts AC
<b>DWV</b>	1500 VAC, 60 HZ. 1 min

Supports PoE, PoE+, and PoE++ per IEEE PoE standards  
IP20 rated per IEC 60529

## MECHANICAL CHARACTERISTICS

<b>Mating Connector Insertion Force</b>	5.0 lbs maximum
<b>Mating Connector Pull Retention Force</b>	20.0 lbs minimum
<b>Durability</b>	750 mating and unmating cycles for 50μ" gold plating
<b>Recommended Soldering Temperature</b>	Lead free reflow soldering up to 260°C for 10 seconds (refer to reflow profile below, maximum of 3 reflow passes permitted)
<b>Operating Temperature</b>	-40°C to +85°C

UL File # E135615  
Connectors are suitable for IR Reflow.

Refer to J-STD-033 for safe handling procedures for SMDs.

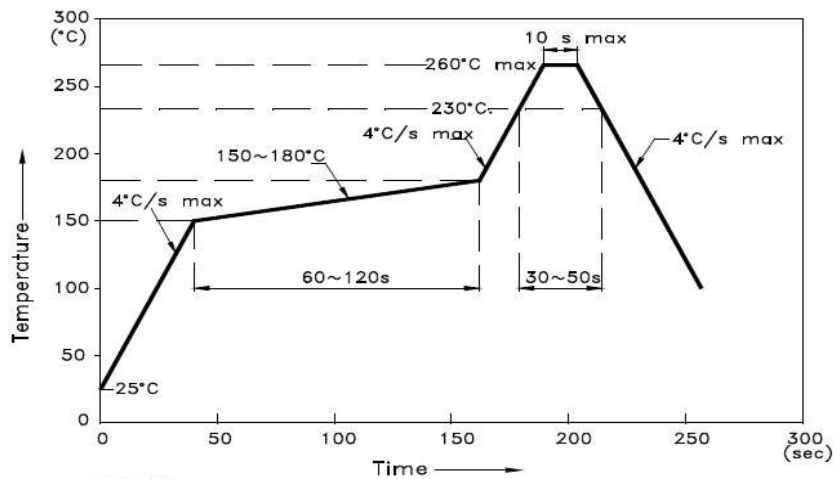

## About Amphenol Commercial Products

Amphenol's commercial connector products are used in a variety of end user applications including networking, telecom, server & computer, storage & HDD, consumer electronics and entertainment, professional audio & Industrial & Military/Aerospace.

## MATERIAL REQUIREMENTS

RJSSE connectors are RoHS compliant.

Unless otherwise specified, the materials for each component shall be:

<b>Insulator</b>	High temperature thermoplastic, flammability rating UL 94V-0
<b>Contacts</b>	-Phosphor Bronze hard temper with gold thickness options (6 $\mu$ ", 15 $\mu$ " 30 $\mu$ ", 50 $\mu$ "") over 50 $\mu$ " minimum Nickel on contact mating area -100 $\mu$ " minimum matte Tin over Nickel on soldering tail
<b>Shield</b>	Copper alloy, Nickel or matte Tin plating
<b>Light Pipe</b>	Optical grade polycarbonate, UL 94V-0

## MOISTURE LEVEL SENSITIVITY

The Moisture Level Sensitivity for the RJSSE connector is MSL-1.

## AVAILABLE DOCUMENTS

Below is a list of the most popular standard sales drawings:

Contact our website, sales, or an authorized Amphenol representation for additional drawings.

<b>RJSSE-7061</b>	Single port, surface mount, unshielded, with light pipes
<b>RJSSE-7060</b>	Single port, surface mount, unshielded, no light pipes
<b>RJSSE-5580</b>	Single port, surface mount, shielded without side tabs, no light pipes
<b>RJSSE-5F80-01T</b>	Single port, surface mount, shield without tabs and boardlock
<b>RJSSE-5383-02T</b>	Two ports, surface mount, shield with EMI tabs, with light pipes

## Related Products

### RJSSE

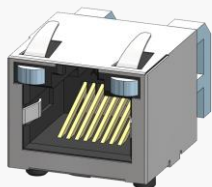

P/N RJSSE-5081 SHOWN  
SINGLE PORT, 8 POSITION,  
WITH SHIELD AND LIGHT PIPE

### RJSAR

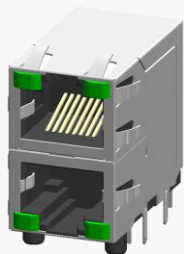

P/N RJSAR-5385-02 SHOWN  
STACKED 2X1, 8 POSITION, WITH  
SHIELD AND LEDs

Amphenol Canada Corp.  
605 Milner Avenue  
Toronto, Ontario, Canada M1B 5X6

www.amphenolcanada.com (www.amphenol-icc.com)  
(416) 291-4401  
sales@amphenolcanada.com

Copyright © Amphenol Corporation 2018 · All rights reserved

Page 3 of 3

Amphenol